

AIR INLET
WITH FILTER

anjos

inspirer le bien-être

FILEA

30 m³/h - ISO ePM1 55 %

Fine particules filter
Installation on windows
In renovation



FILEA 30

- Fine particules filter / Filtration efficiency : ISO ePM1 55%
- Removable filters without tools
- 30m³/h under 20 Pa
- Made of ABS plastic
- Other colors : bronze, grey, anthracite grey and black
- Used in refurbishment

Presentation

The air-inlets FILEA 30 are used to supply new air in the main rooms of a dwelling with single flow mechanical ventilation system.



The **FILEA 30** (set airflow 30m³/h) which filter is efficient according to the norm ISO 16890-1 (2016)

ePM ₁₀	ePM _{2,5}	ePM ₁
89%	69%	58%

Made of polystyrene, the air-inlet is used inside the main rooms (living and bedrooms) for new air-supply in single flow mechanical ventilation system.

The outer cover for outside is made of UV and weather resistant ASA. Available in the same color than the inlet.

Indoors

FILEA 30

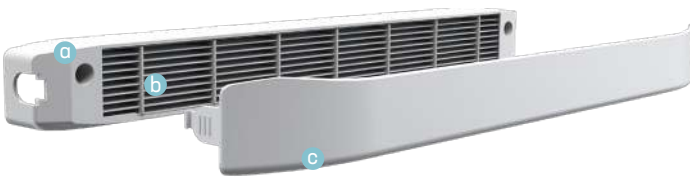

Installed on the joinery on a unique mortise of **354 x 12 mm**.

W. (mm)	H. (mm)	Th. (mm)
421	44	50

- a Base
- b Filter
- c Front face
- d Outer cover CE2A
- e Exterior acoustic cover CFA

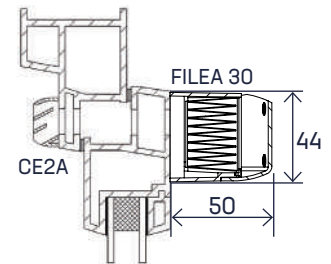

Outdoor

CE2A



The outer cover **CE2A** made of white ABS ASA must absolutely be fixed on sheltered areas. In other case, contact ANJOS.

The CE2A are fixed on a mortise of 354 x 12 mm.

W. (mm)	H. (mm)	Th. (mm)
400	23	12

CFA



Installation A



Installation B

Made of aluminum with an acoustic element, the **CFA** acoustic front cover improves the sound insulation of the air inlet. It is installed in place of the CE2A cover.

Mounting on surfaces sheltered from the weather.

L. (mm)	H. (mm)	Thk. (mm)
390	35	45

CFA is mounted on a slot size **354 x 12 mm**.

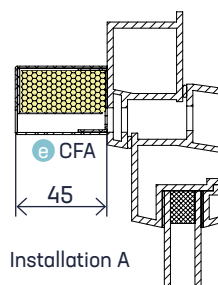

Installation A

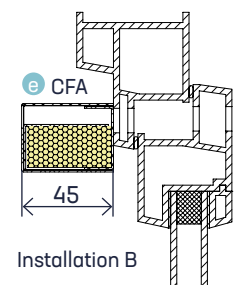

Installation B

Installation

Press the 2 clips on each side **1** to remove the front face **2**.
Fix the air-inlet with 2 screws. Click back the front cover by fixing correctly the clips.

On the outside, the outer cover is centered on the mortise fixed by 3 screws.

The components must remain easily accessible for cleaning.

The air-inlet and the outer cover are mounted on the joinery on a slot of 354 x 12 mm :

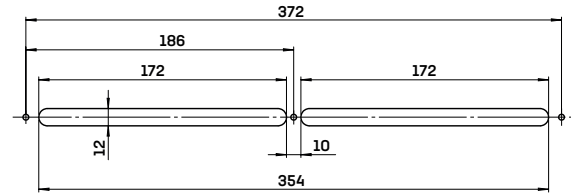

Maintenance

The filter must be changed at least once a year.

- Press the 2 clips placed on each side **1**
- Remove the front cover **2**
- Pull the filter to get it out from the air-inlet
- Insert the new filter back placing it behind the support strips, on each side.
- Put back the front cover
- Reinstall the front flange of the air inlet.



Use only the Anjos filters.



Filtration

Efficiency



The air-inlet FILEA 30 is equipped with a fine particles filter. Initial efficiency according to the norm ISO 16890-1 (2016).

Aeraulic

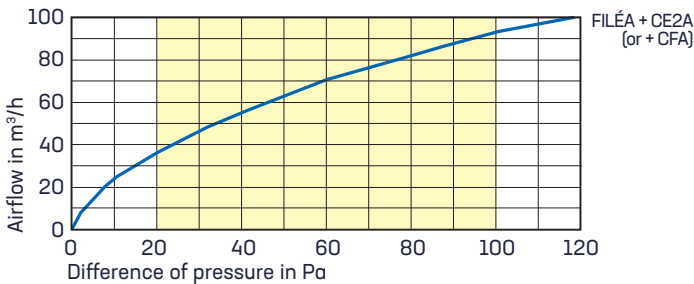

The curve opposite shows the nominal air-flow characteristics according to the humidity level in the air and for a difference of pressure of 20 Pa.

Colours

RAL	9016	8019	7016	9011
	White	BRonze	G7 anthracite	NO black

Acoustic

Air inlets are characterised by their acoustic performance $D_{n,e,w}$ (Ctr).

Type	$D_{n,e,w}$ (C)	$D_{n,e,w}$ (Ctr)
FILEA 30 + CE2A*	35 dB	34 dB
FILEA 30 + CFA	39 dB	38 dB

*Similar acoustic characteristics without outer cover CE2A.

Products coding

Designation	Code	Pckg.
Air inlet FILEA 30 white	0301	35
Air inlet FILEA 30 white + CE2A	0302	22
Air inlet FILEA 30 white + CFA	0306	18
Filter for FILEA 30	0305	50

Designation	Code	Pckg.
Outer cover CE2A	0146	250
Exterior acoustic cover CFA (anodized aluminium)	0194	44
Exterior acoustic cover CFA (white lacquered aluminium)	0195	44
Exterior acoustic cover CFA (black lacquered aluminium)	0196	44

anjos