

METAL VENTS  
Exhaust - supply

**anjos**

inspirer le bien-être

# TMM - TMP

Ø 80 to 200 mm

Aluminium

Ceiling or wall mounting

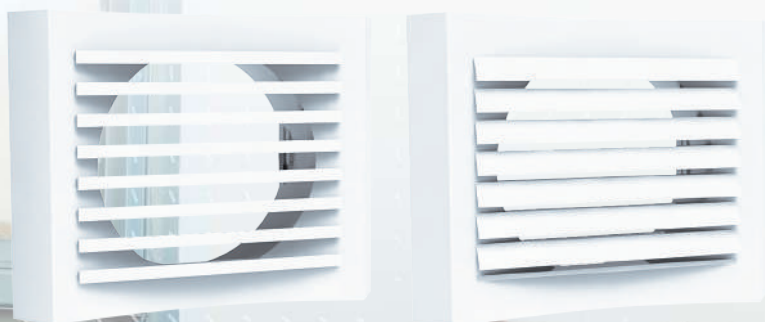

# TMM - TMP

- Two models: TMM (walls) and TMP (ceilings)
- TMM fits inside collars and TMP inside plasterboard sleeves
- Both models are made entirely of aluminium with a white finish (grey available on request)
- May be combined with a flow regulator or damper placed inside a duct

## Presentation

TMM (wall) and TMP (ceiling) metal vents are used to supply and exhaust air in single and dual-flow mechanical extract ventilation systems. They are specially designed for use in commercial spaces fitted with ducts measuring between 80 and 200 mm in diameter.

## Components

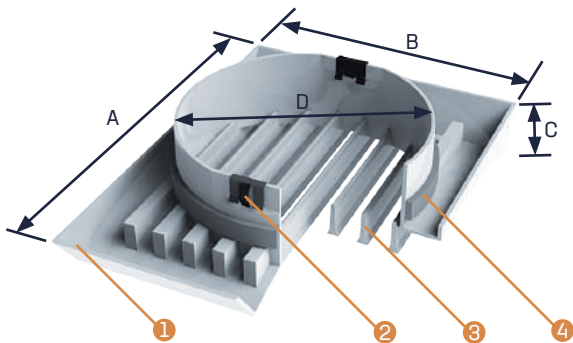

	A (mm)	B (mm)	C (mm)	D (mm)	Weight(gr)	S (cm <sup>2</sup> )
TMM 80	131	105	16	75	200	26
TMM 100	155	127	16	95	265	40
TMM 125	196	150	22	120	440	63
TMM 160	251	190	22	155	735	110
TMM 200	305	230	22	195	965	176
TMP 80	131	105	16	75	205	18
TMP 100	155	127	16	95	285	29
TMP 125	196	150	22	120	430	46
TMP 160	251	190	22	155	720	77
TMP 200	305	230	22	195	950	91

① Made of injected aluminium ② Two steel attachment clips ③ Airfoil grille (louvres on TMP) made of extruded aluminium attached to the casing ④ M1 foam sealing gasket.

## Installation

These metal vents push-fit directly into 50 mm-long MTM collars fitted in walls or into 100 or 150 mm-long MPTM plasterboard sleeves fitted in ceilings.

They are held in place by two clips and sealed with a foam gasket sealing.

They are easy to remove and refit for maintenance.

### MTM COLLAR

Galvanised steel collar, for bonding inside ducts.

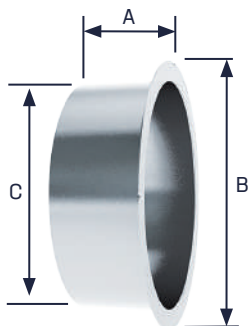

### MPTM PLASTERBOARD SLEEVE

Galvanised steel with three prongs for a secure fit.



	A (mm)	B (mm)	C (mm)
MTM 80	45	98	78
MTM 100	47	121	98
MTM 125	47	144	123
MTM 160	51	184	158
MTM 200	52	224	198
MPTM 80	105	96	78
MPTM 100	105/150	120/115 (lg. 150)	98
MPTM 125	105/150	143/144 (lg. 150)	123
MPTM 160	105/150	178/181 (lg. 150)	158
MPTM 200	105/150	218/222 (lg. 150)	198



## Characteristics

### Product codes

Description	Code
Metal wall vent - dia. 80 mm - TMM 80	1100
Metal wall vent - dia. 100 mm - TMM 100	1101
Metal wall vent - dia. 125 mm - TMM 125	1102
Metal wall vent - dia. 160 mm - TMM 160	1103
Metal wall vent - dia. 200 mm - TMM 200	1104

Description	Code
Metal ceiling vent - dia. 80 mm - TMP 80	1105
Metal ceiling vent - dia. 100 mm - TMP 100	1106
Metal ceiling vent - dia. 125 mm - TMP 125	1107
Metal ceiling vent - dia. 160 mm - TMP 160	1108
Metal ceiling vent - dia. 200 mm - TMP 200	1109

### MPTM plasterboard sleeves

Description	Code
Plasterboard - dia. 80 mm × L 100 mm	1129
Plasterboard - dia. 100 mm × L 100 mm	1130
Plasterboard - dia. 125 mm × L 100 mm	1131
Plasterboard - dia. 160 mm × L 100 mm	1132
Plasterboard - dia. 200 mm × L 100 mm	1133
Plasterboard - dia. 100 mm × L 150 mm	1116
Plasterboard - dia. 125 mm × L 150 mm	1117
Plasterboard - dia. 160 mm × L 150 mm	1118
Plasterboard - dia. 200 mm × L 150 mm	1120
Plasterboard - dia. 160/150 × L 150 mm	1119

### MTM collars

Description	Code
dia. 80 mm collar for TMM and TMP	1110
dia. 100 mm collar for TMM and TMP	1111
dia. 125 mm collar for TMM and TMP	1112
dia. 160 mm collar for TMM and TMP	1113
dia. 200 mm collar for TMM and TMP	1114